

2 ROOF PLAN
A201 SCALE: 1:200

LEGEND

- 100 DOOR NUMBER, SEE 2/A001 FOR DOOR SCHEDULE
- W1 WALL OR PARTITION TYPE, SEE 1/A001 FOR DESCRIPTION
- W1 EXTERIOR WINDOW DESIGNATION, SEE 1/A002
- 1 hr FIRE SEPARATION
- 2 hr FIRE SEPARATION

NOTES

- DO NOT RELY UPON INFORMATION SHOWN ON THIS DRAWING FOR CONSTRUCTION UNLESS IT STATES BELOW THE SHEET HAS BEEN SPECIFICALLY ISSUED FOR THAT PURPOSE AND THE SHEET HAS BEEN STAMPED AND SIGNED.
- DO NOT SCALE FROM THIS DRAWING.
- ALL DIMENSIONS ARE IN MILLIMETRES (mm) UNLESS OTHERWISE NOTED
- CONFIRM CONDITIONS ON SITE BEFORE PROCEEDING WITH THIS WORK.
- ENSURE ALL PERMITS AND APPROVALS ARE IN PLACE BEFORE COMMENCING WORK.
- SCALE IS HALF OF WHAT IS SHOWN IF PRINTED ON 11"x17" PAPER

DRAFT - NOT FOR CONSTRUCTION

PRIME CONSULTANT
WOODFORD/SHEPPARD
ARCHITECTURE LTD.
11 Rowan Street
St. John's Newfoundland Canada
709 753 7917
info@woodfordsheppard.com

CONSULTANT
ATLANTIC ENGINEERING CONSULTANTS LTD.
CIVIL, STRUCTURAL, MUNICIPAL, ELECTRICAL, MECHANICAL
ENGINEERS, PLANNERS AND PROJECT MANAGERS
34 Main Street, Corner Brook, Newfoundland A2H 1C3
(709) 634-3612 Fax No(709)634-4628

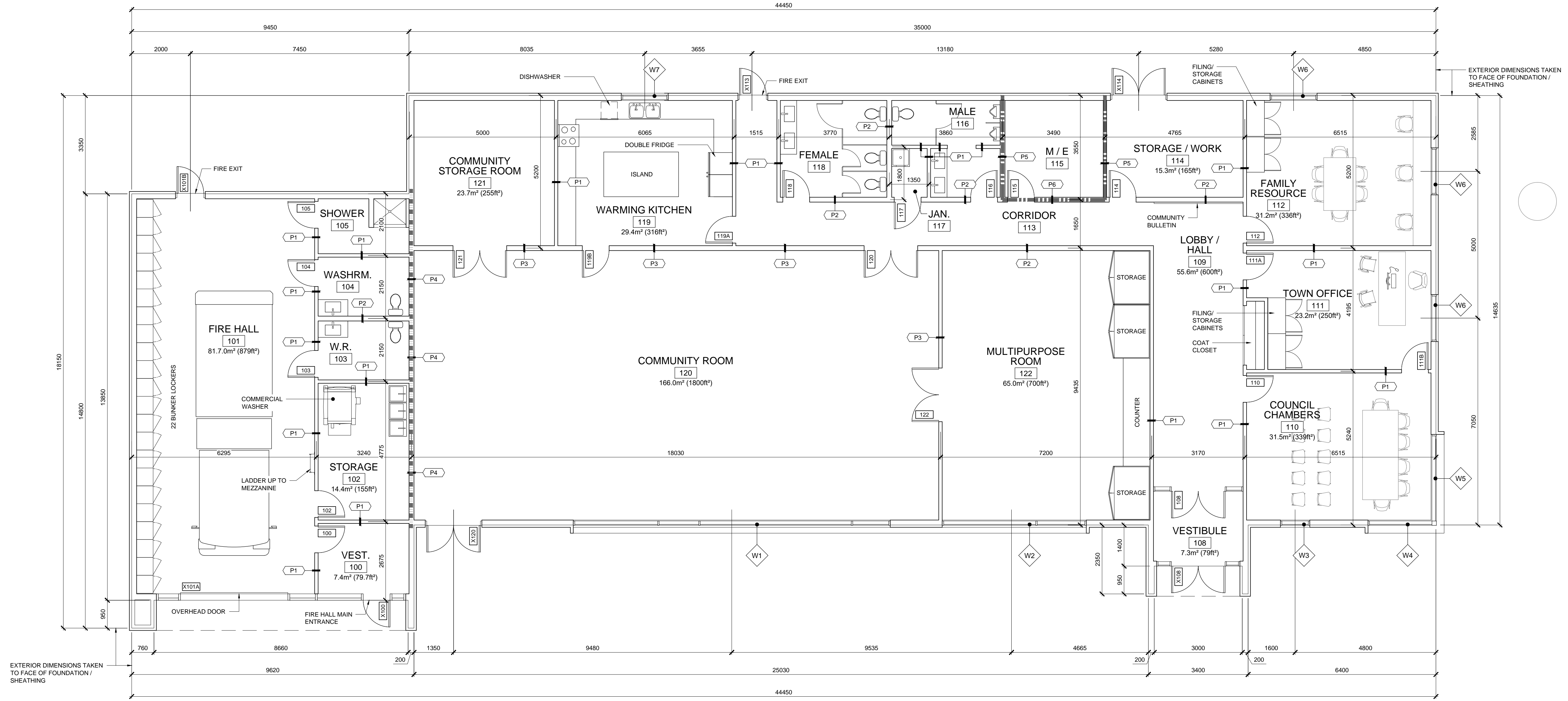

1 FLOOR PLAN
A201 SCALE: 1:75

GROSS FLOOR AREA
COMMUNITY CENTRE: 520m² (5,595ft²)
FIRE HALL: 135m² (1,450ft²)
TOTAL BUILDING: 655m² (7,045ft²)

No.	By	DESCRIPTION	Date
F	CW	FOR REVIEW	2017-09-12
E	CW	FOR DESIGN DEVELOPMENT	2017-06-26
D	CW	FOR CONCEPT DESIGN	2017-05-29
C	CW	FOR REVIEW	2017-05-05
B	CW	FOR REVIEW	2017-03-14
A	CW	FOR REVIEW	2017-02-21

REVISIONS

CLIENT
TOWN OF L'ANSE AU CLAIR

PROJECT
L'ANSE AU CLAIR COMMUNITY CENTRE + TOWN OFFICE

DESIGNED	DRAWN	SCALE
-	-	AS NOTED
APPROVED	DATE	SHEET
-	2017/02/21	-
PROJECT NO.	2016-022	A201